



iX4

DX-4100/4200/4300 Series

Peeler Quick Installation Guide
剝紙器快速安裝指南
剥纸器快速安装指南
Guía de instalación rápida del pelador
Guia de instalação rápida de descascador
Guide d'installation rapide de l'éplucheur
Schäler Schnellinstallationsanleitung
Guida all'installazione rapida della pelatrice
Soyma Makinesi Hızlı Kurulum Kılavuzu
Panduan Instalasi Cepat Pengupas
Skalare Snabbinstallationsguide
필러 빠른 설치 가이드
Snelle installatiehandleiding schiller
Skrócona instrukcja montażu odklejaka
Инструкция по установке отделителя этикеток



Revision Date : Jul. 2020

Note:

*Specifications, accessories, parts and programs are subject to change without notice.

Argox Information Co., Ltd.

7F., No.126, Ln.235, Baoqiao Rd., Xindian Dist.,
New Taipei City 231, Taiwan (R.O.C.)
Tel: +886-2-8912-1121 Fax: +886-2-8912-1124
<http://www.argo.com>
<https://www.youtube.com/user/argoxmkt>
email:service@argox.com

Copyright © 2020. Argox Information Co., Ltd. All Rights Reserved.

START

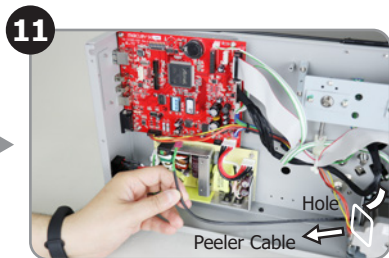
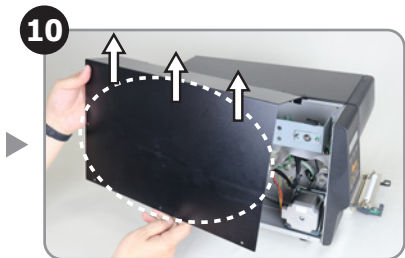
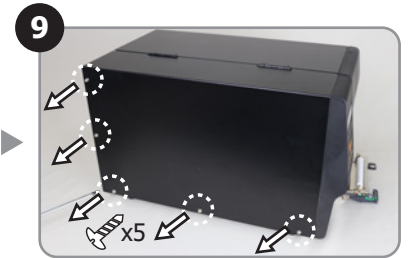
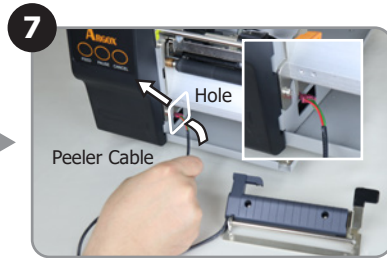
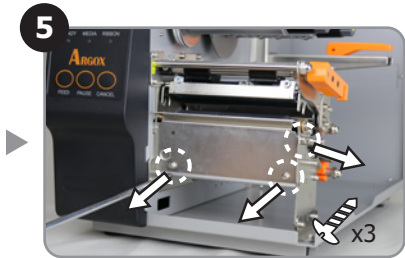
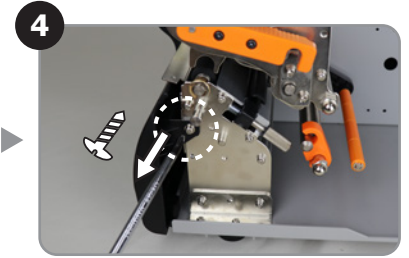
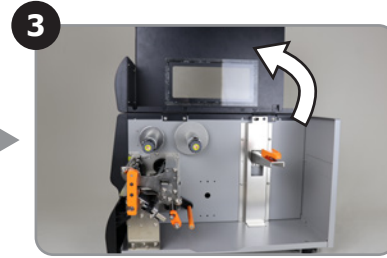
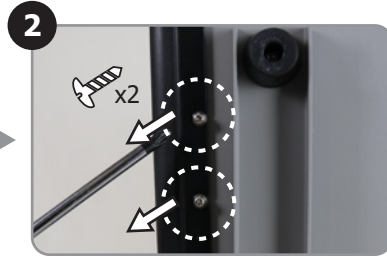
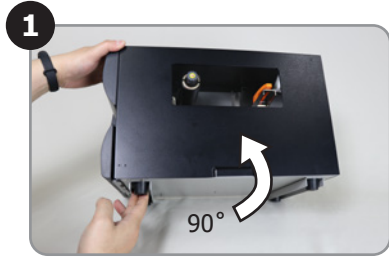

※ Cutter cable also goes through this hole

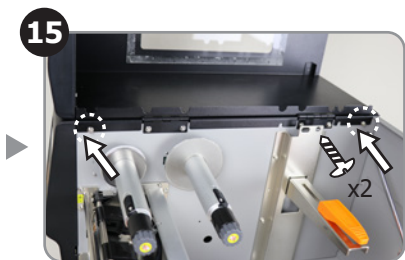
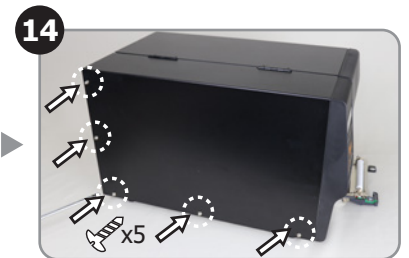
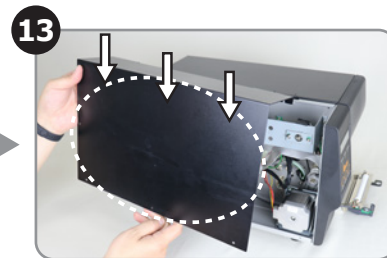
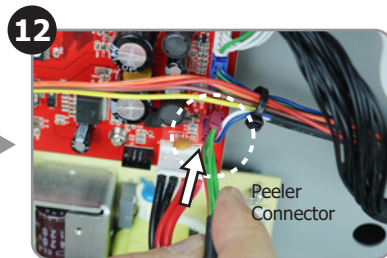

※ Screw at the utmost left and right sides

